

PROFIL TRANSVERSAL PROPUS PLATFORMA CAROSABILA

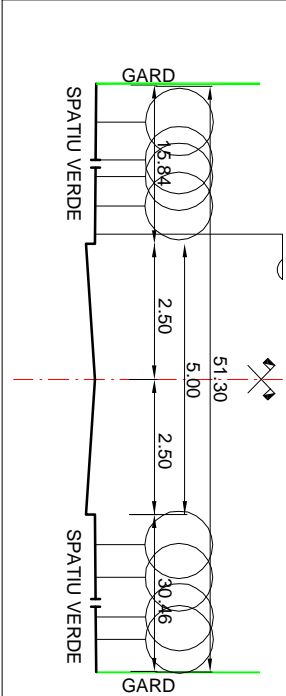

PROFIL TRANSVERSAL PROPUS DRUM

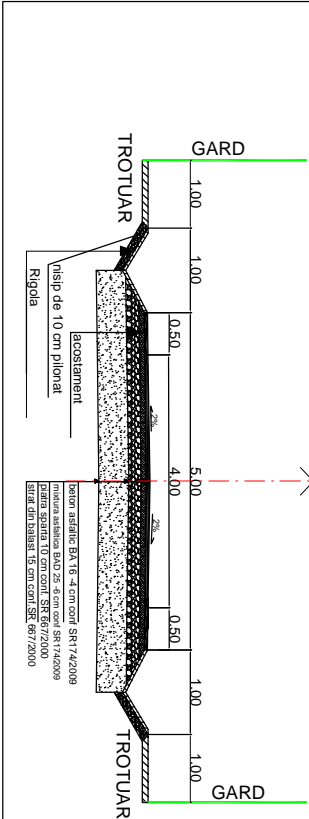

PLAN URBANISTIC ZONAL

comuna Slătioara, sat Rugețu,punct ``Chelet`` jud. Valcea

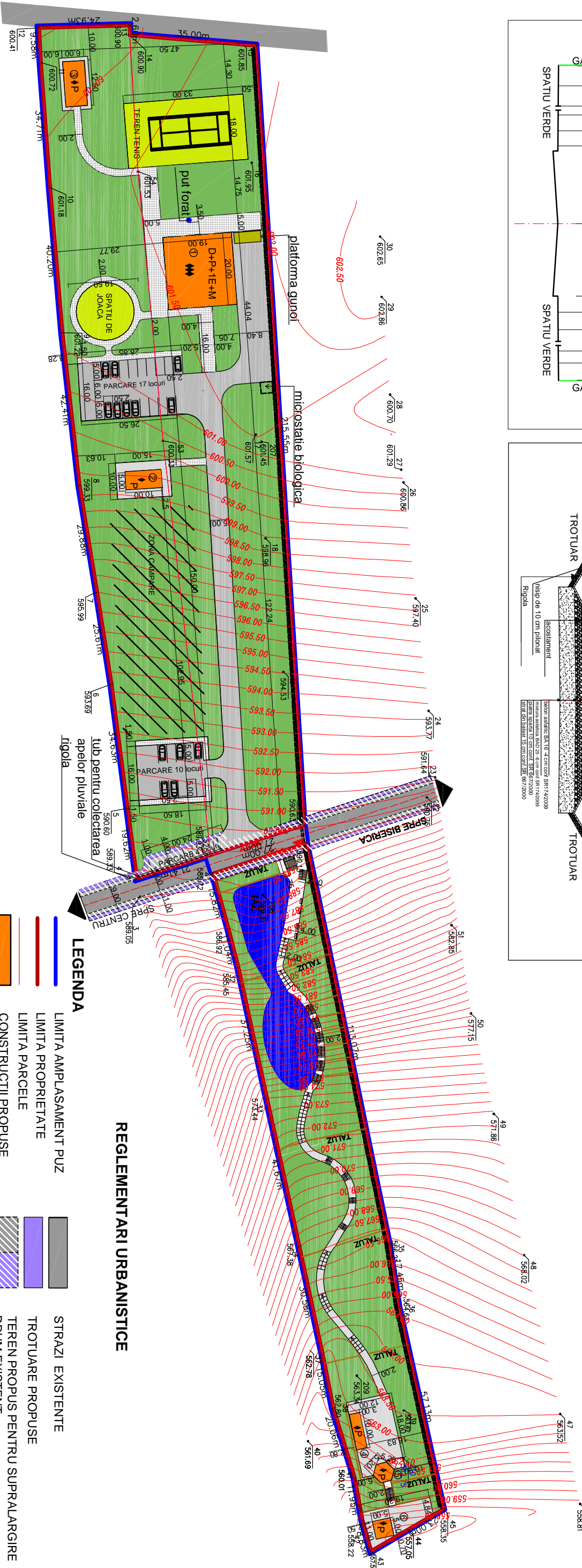
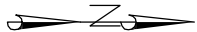

BILANT TERITORIAL ZONAL

DENUMIREA ZONEI FUNCTIONALE	SUPRAFATA TEREN (mp) EXISTENT	% TEREN EXISTENT	SUPRAFATA TEREN (mp) PROPUS	% TEREN PROPUS
ZONA FANETA	17083.00mp	100.00%	-	-
ZONA CONSTRUCȚII TURISTICE	-	-	583.80mp	3.41%
ZONA PLATFORME AMENAJATE PT. C-TII	-	-	464.00mp	2.71%
ZONA SPATII VERZI AMENAJATE	-	-	9713.50mp	56.93%
ZONA CAMPARE	-	-	1420.00mp	8.31%
ZONA TEREN SPORT/ SPATII DE JOACA	-	-	796.00mp	4.65%
ZONA IAZ	-	-	612.00mp	3.58%
ZONA ALEI DALATE/ TROTUARE	-	-	1281.00mp	7.49%
ZONA PLATFORMA CAROSABILA SI PARCARI	-	-	1965.70mp	11.50%
ZONA PLATFORMA GOSPODAREASCA	-	-	22.00mp	0.12%
ZONA CEDATA DOMENIULUI PUBLIC	-	-	225.00mp	1.30%
TOTAL SUPRAFATA TEREN STUDIAT	-	-	17083.00mp	100.00%

LEGENDA

	LIMITA AMPLASAMENT PUZ		STRAZI EXISTENTE
	LIMITA PROPRIETATE		TROTUARE PROPUSE
	LIMITA PARCELE		TEREN PROPUS PENTRU SUPRALARGIRE
	CONSTRUCȚII PROPUSE		DRUM EXISTENT
	1 Pensiune		PLATFORME CAROSABILE PROPUSE
	2 Foisor		ALEI DALATE/ TROTUARE PROPUSE
	3 Anexa personal		PLATFORME C-TII PROPUSE
	4 Spatii expozate obiecte traditionale romanesti		PLATFORMA GOSPODAREASCA
	5 Foisor		ZIDURI DE SPRUJIN
	6 Moara		RIGOLE
	SPATII VERZI PROPUSE		REGIM DE INALTIME
	ZONA CAMPARE		ACCES AUTO
	SPATII DE JOACA /TERENURI		ACCES PIETONAL
	SPORT PROPUSE		
	IAZ		

REGLEMENTARI URBANISTICE

POT maxim propus 35 %
CUT maxim propus 0.3

S.C. COMPATIBIL S.R.L.			Beneficiar:	Proiect nr. 01
NR. REG. COM. J38 / 577 / 1997, CUI RO9856680			S.C. TIMP SI VREMURI GRUP S.R.L.	
RM. VALCEA, STR. G-RAL. MAGHERU NR. 25, TEL/FAX 0350.80.95.97			comuna Slătioara, sat Rugețu,punct ``Chelet`` jud. Valcea	
SPECIFICATIE	NUME	SEMNATURA	Scara: 1:1.000	Faza: PUZ
SEF PROIECT	arh. IOAN MARCELA			
PROIECTANT	urb. Mihailicu Cristina			
DESENAT	urb. Mihailicu Cristina		Data: 2011	Titlu planșă: PROPUNERI DE INTERVENTIE
				Planșa nr. 03